

Pre-RFP Meeting
**ANW Surgical &
Critical Care Pavilion**

June 8, 2023



01

WELCOME

01 - WELCOME & INTRODUCTIONS

02 - PROJECT OVERVIEW

03 - COMMUNITY EMPOWERMENT

04 - RFP OVERVIEW

QUESTIONS

PROJECT TEAM



OWNER



CONSTRUCTION MANAGER



**ARCHITECT &
DESIGN FIRM**

INTRODUCTIONS

Shanae Phillips
Sr. Community Empowerment Mgr.
Mortenson



Sydney Wittmier
Project Executive
Mortenson



Mike Labukas
Project Executive
Mortenson



Nate Thompson
Sr. Project Manager
Mortenson



Kevin Heisdorffer
Senior Design Phase Manager
Mortenson



02

PROJECT OVERVIEW

PROJECT SCHEDULE

MILESTONES

PROCUREMENT TIMELINE

▶▶ ABBOTT NORTHWESTERN HOSPITAL



▶▶ SURGICAL AND CRITICAL CARE PAVILION



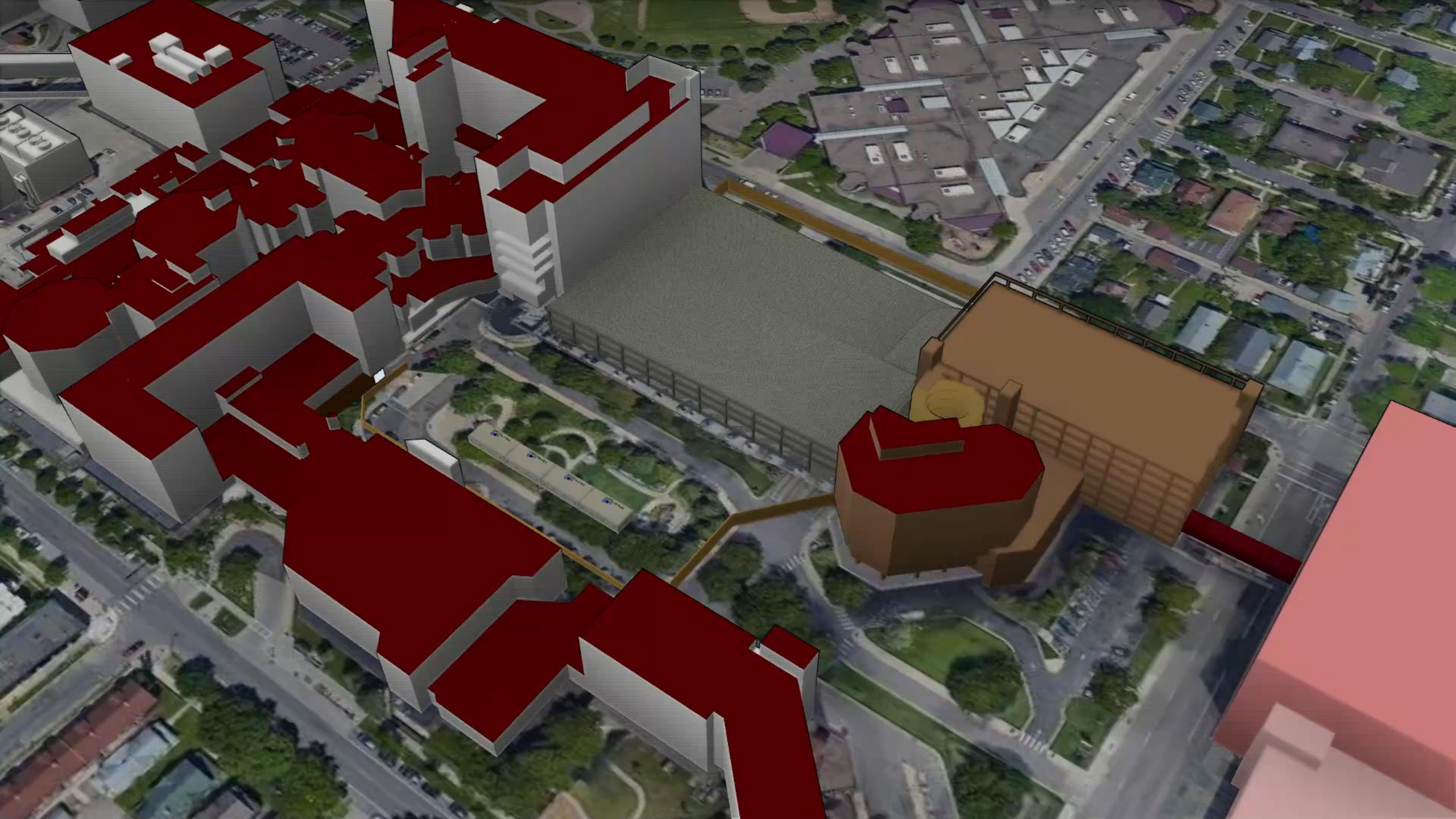

SURGICAL AND CRITICAL CARE PAVILION



SURGICAL AND CRITICAL CARE PAVILION



▶▶ MILESTONE SCHEDULE

Demo Parking Ramp.....	August 2023
Foundations Start.....	Early 2024
Structure Complete.....	Late 2025
Enclosure Start.....	Mid 2024
Finishes.....	Early 2024
Substantial Completion.....	Mid 2026

▶▶ PROCUREMENT SCHEDULE

- ▶ Enabling Work Scopes Awarded to Date: Skyways & Temporary Conditions - Complete
- ▶ Care Pavilion Scopes Awarded to Date
 - ▶ Mechanical (Harris)
 - ▶ Electrical (Parsons)
 - ▶ DIRTT Walls (The Berg Group)
 - ▶ Earthwork (Bolander)
 - ▶ Curtainwall (Empirehouse)



▶▶ PROCUREMENT SCHEDULE

▶ Bid Package #1 – October 2022

- DIRT Walls (The Berg Group)

▶ Bid Package #2 – October 2022

- Mechanical/Plumbing (Harris)
- Electrical (Parsons)

▶ Bid Package #3 – January 2023

- Earthwork (Bolander)
- Curtainwall (Empirehouse)

▶ Bid Package #4 (CP-1) – June 2023

- Concrete
 - Ready Mix Supply, Rebar Supply, PT Supply, Rebar Install, Forming, Pumping
- Waterproofing
- Metal Panel/Terracotta
- Fire Protection

▶▶ PROCUREMENT SCHEDULE

▶ Bid Package #5 (CP-2) – August 2023

- Structure
- Roofing
- Remaining Enclosure

▶ Bid Package #6 (CP-3) – October 2023

- Drywall
- Finishes
- Site Improvements

03

COMMUNITY EMPOWERMENT

▶▶ COMMUNITY EMPOWERMENT

SUPPLIER DIVERSITY GOAL

30% Women and Minority Business Enterprises (WMBE)

Proof of certification from one of the following agencies:

- ▶ Minnesota United Certification Program (MNUCP)
- ▶ Central (CERT) Certification Program
- ▶ State of MN – TG/ED/VO Directory
- ▶ Women’s Business Enterprise National Council (WBENC) and regional affiliates
- ▶ National Minority Supplier Development Council and regional chapters



▶▶ COMMUNITY EMPOWERMENT

WORKFORCE DIVERSITY GOAL

32% People of Color

20% Women

- ▶ Expressed as a percentage of work hours
- ▶ Applies to all on-site construction trade workers
- ▶ Prevailing wages to be paid to all workers performing work on the project
- ▶ Workers must be paid bi-weekly at a minimum



▶▶ COMMUNITY EMPOWERMENT

COMMUNITY WORKFORCE PROGRAM (CWP)

Purpose

- ▶ To provide construction entry level employment opportunities for neighborhood residents (emphasis on women and people of color)
- ▶ Participants will gain short-term, hands-on experience (a gateway to a long-term career in the industry)

Trade Partner Expectations

- ▶ Participants may have little to no construction experience
- ▶ Focus on craft/trade workers
- ▶ Referral process in place to connect potential workers with trade partners
- ▶ Once referred, people are subject to your normal hiring process
- ▶ **Expect all trade partners to participate in CWP (minimum 2 workers)**

▶▶ COMMUNITY EMPOWERMENT

REPORTING & MONITORING

- ▶ LCPtracker – weekly payroll entries required
- ▶ B2GNow – monthly payment entries required



COMMUNITY EMPOWERMENT

REQUIRED FORMS

WMBE Outreach & Commitment Form

- ▶ Part I – Indicate outreach to WMBE firms
- ▶ Part II – Indicate WMBE commitments
- ▶ Include copies of valid certificates

Page 1 of 2

**WOMAN AND MINORITY BUSINESS ENTERPRISE (WMBE)
OUTREACH AND COMMITMENT FORM**



Proposer Company Name: _____ Contract Category: _____

Part I – Indicate all outreach you have performed to certified WMBEs related to your bid/proposal. Outreach should be made to a minimum of three (3) certified WMBEs. Please add additional rows if needed.

Name of Firm (legal business name used for certification)	Certification (check all that apply)		Date of Contact	Method of Contact (phone, email, etc.)	If bid submitted, amount of bid	Offer accepted/declined?	Reason(s) for declining
	WBE	MBE					

Part II – Indicate all certified WMBEs your firm intends to use if awarded this contract. For all WMBEs identified, proof of certification must be attached. Please add additional rows if needed.

Name of Firm (legal business name used for certification)	Certification (check all that apply)		How will the firm participate? (subcontractor, consortium, joint venture, etc.)	Description of Work	Estimated Dollar Value of Participation	Estimated % of Total Proposal
	WBE	MBE				

Total Dollar Value of WMBE Participation: \$ _____

Total Percentage of WMBE Participation: _____%

04

RFP OVERVIEW

▶▶ RFP OVERVIEW

▶ Lump Sum Bid Proposals:

- ▶ 1.01a – Concrete Ready Mix Supply (Based on CP-1 & DDs)
- ▶ 1.01b – Reinforcing Steel Supply (Based on CP-1 & DDs)
- ▶ 1.01c – Post Tension Cable Supply (Based on CP-1 & DDs)
- ▶ 1.01d – Reinforcing Steel Erection (Based on CP-1 & DDs)
- ▶ 1.01e – Concrete Formwork (Based on CP-1 & DDs)
- ▶ 1.01f – Concrete Pumping (Based on CP-1 & DDs)
- ▶ 1.02 – Damproofing & Waterproofing (Based on CP-1)
- ▶ 1.03 – Fire Protection (Based on DDs)
- ▶ 1.04 – Metal Panels/Terracotta (Based on DDs)

▶▶ RFP OVERVIEW

- ▶ Bid Manual & Instructions to Bidders (including Supplementary Terms)
- ▶ Subcontract Agreement / Purchase Agreement
- ▶ Section 3 Scopes of Work
- ▶ Project Schedule
- ▶ Tax Exempt
- ▶ Project Labor Agreement
- ▶ Union / Prevailing Wage (include whichever is greater)
- ▶ Prequalification
- ▶ SDI / Performance and Payment Bonds
- ▶ Community Empowerment



▶▶ RFP SCHEDULE

- ▶ Construction Documents Issued May 30, 2023
- ▶ RFP Proposal Manual Issued May 31, 2023
- ▶ Pre-bid Meeting June 8, 2023 @ 3:30pm
- ▶ **Bid Proposals Due June 22, 2023 @ 12:00pm**

Submit (1) electronic copy of bid proposal to Brad Kruse & Kevin Heisdorffer

QUESTIONS?



CONTACTS

- MIKE LABUKAS
- Project Executive
- mike.labukas@mortenson.com
- 612.508.6867
- SHANAE PHILLIPS
- Sr. Community Empowerment Mgr.
- shanae.phillips@mortenson.com
- 320.493.3424